

RCH Series Power Inductors

RCH-108

Dimensions(mm)

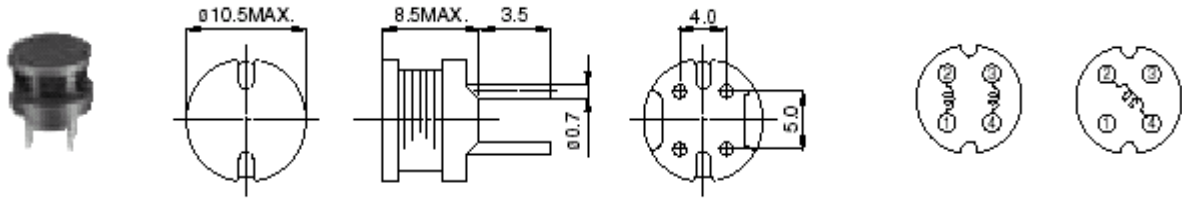

(10 μ H – 1.0mH)

(10 μ H – 15 μ H) (18 μ H – 1mH)

(BOTTOM VIEW)

Specifications

Parts No.	Inductance	DCR.(Max) Typical /Rated DC. Current (A)	Parts No.	Inductance	DCR.(Max) Typical /Rated DC. Current (A)
6R3	6.3uH		561	560uH	1.200(0.820)/0.60
7R5	7.5uH		681	680uH	1.400(0.950)/0.55
8R8	8.8uH		821	820uH	1.800(1.250)/0.50
100	10uH	0.027(0.017)/4.50	102	1.0mH	2.100(1.460)/0.45
120	12uH	0.031(0.020)/4.10	122	1.2mH	
150	15uH	0.036(0.024)/3.70	152	1.5mH	
180	18uH	0.049(0.031)/3.40	182	1.8mH	
220	22uH	0.055(0.035)/3.10	222	2.2mH	
270	27uH	0.062(0.039)/2.80	272	2.7mH	
330	33uH	0.079(0.053)/2.50	332	3.3mH	
390	39uH	0.087(0.058)/2.30	392	3.9mH	
470	47uH	0.099(0.067)/2.10	472	4.7mH	
560	56uH	0.130(0.83)/1.90	562	5.6mH	
680	68uH	0.140(0.096)/1.70	682	6.8mH	
820	82uH	0.160(0.110)/1.60	822	8.2mH	
101	100uH	0.210(0.150)/1.40	103	10mH	
121	120uH	0.240(0.170)/1.30	123	12mH	
151	150uH	0.320(0.220)/1.20	153	15mH	
181	180uH	0.350(0.240)/1.10	183	18mH	
221	220uH	0.450(0.320)/0.96	223	22mH	
271	270uH	0.610(0.430)/0.87	273	27mH	
331	330uH	0.690(0.490)/0.79	333	33mH	
391	390uH	0.780(0.550)/0.72	393	39mH	
471	470uH	1.000(0.790)/0.66	473	47mH	

Tolerance of Inductance: 10uH-27uH \pm 20% (M); 33uH-1.0mH \pm 10% (K)

Test Frequency:L 10uH-82uH (2.52MHz); 100uH-47mH (1KHz).

This indicates the value of the current when the inductance is 10% lower than its initial value at D.C. superimposition or D.C. current when at $t=40^{\circ}\text{C}$, whichever is lower. ($T_a=20^{\circ}\text{C}$)